

DESCRIPTION:

Thermodynamic steam trap with integral strainer, in forged carbon steel construction, for steam mains, tracers, headers & drip legs.

SALIENT FEATURES:

Complete replaceable working parts (disc and seat) facilitate economical and easy maintenance.

Hardened and lapped disc and seat provide steam tight seal, withstanding continuous and prolonged operation.

Condensate entry below the disc, concentric to the disc / seat and the three port discharge ensures a clean parallel lift of the disc with reference to the seat, eliminating localised wear and tear.

Ideal for fluctuating loads and pressures.

Perfect shut off, no steam loss.

Robust, maintenance free, fully guaranteed

SIZES : 15, 20 mm NB (1/2", 3/4")

CONNECTIONS: Screwed (BSP/ BSPT/ NPT)
Socket weld, Flanged*, Buttweld.

*End connection flanges of ASTM A105 forged carbon steel are welded on.

Non IBR¹

LIMITING CONDITIONS:

PMA: Maximum allowable pressure	50/55 kg/cm ² (g)
TMA: Maximum allowable temperature	426°C
Maximum operating back pressure at the outlet should not exceed 80% of the inlet pressure.	
Minimum differential pressure for satisfactory operation	0.25 kg/cm ²

INSTALLATION:

The trap will operate in any position but the preferred installation is in the horizontal plane with the disc cap on the top. Full port isolating valves should be installed upstream and downstream of the trap. Always open isolation valves slowly until normal operating conditions are achieved to avoid system shocks.

¹Indian Boiler Regulations



MAINTENANCE:

The trap can be maintained inline without disturbing the piping connections. Ensure that the trap is isolated - upstream and downstream - before attempting to dismantle it. **ALLOW THE TRAP TO COOL BEFORE DISMANTLING.**

For trouble-free performance, periodic cleaning of the disc and seat is recommended.

Do not use corrosive media for cleaning.

Only the disc and seat are subject to wear.

A worn disc and seat can be replaced, preferably as a set, along with the gaskets.

IMPORTANT:

The trap should be installed as close as possible to the system drain point. For new installations, the system should be properly flushed prior to fitting the trap.



MATERIAL:

No.	PART	MATERIAL	QTY.(Nos.)
1.	BODY	ASTM A105	01
2.	DISC CAP	ASTM A743 CA 40	01
3.	STRAINER CAP	ASTM A743 CA 40	01
4.	STRAINER SCREEN	AISI 304	01
5.	DISC (Hardened)	AISI 410 / 420 / D2	01
6.	DISC SEAT (Hardened)	AISI 420 / D2	01
7&8.	GASKET	SPIRAL WOUND SS 304 WITH GRAFOIL FILLER	02
9.	LOCATOR	AISI 304	01
10.*	ISOTUB	MS / SS	01

*OPTIONAL FITTINGS:

ISOTUB: An insulating cover reduces the effect of excessive heat loss resulting from low ambient temperatures, wind, rain, etc.

BLOW -OFF COCK: When the blow-off cock is opened, loose material collected in the strainer is purged.

DIMENSIONS: (approx.) in mm.

A	B	C	D	E	F	Wt.(kg.)
85	102	55	85	40.5	48.5	1.3

FOR FLANGED TRAPS

Size/Flange Rating	G	Wt.(kg.)approx.
½" # 150	162	2.4
½" # 300	171	2.5
¾" # 150	165	2.5
¾" # 300	175	2.7

Flange ends #600 available on request.

AVAILABLE SPARES:

Disc, Disc Seat, Gaskets, Strainer Screen (Packet of 5), Isotub

HOW TO ORDER:

PT17, 15NB, BSP, NIBR
ORDERING INFORMATION:

- 1) Inlet Pressure (kg/cm²(g))
- 2) Back Pressure (kg/cm²(g))
- 3) Operating Temperature (°C)
- 4) Condensate Load (kg/hr)
- 5) Size & Model
- 6) End Connections
- 7) IBR / NIBR

Local regulations may restrict the use of this product below the conditions quoted. Limiting conditions refer to standard connections only. In the interest of development and improvement of the product, we reserve the right to change the specifications without prior notice.

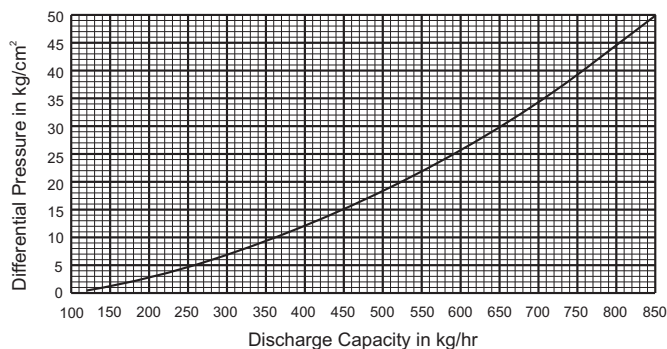
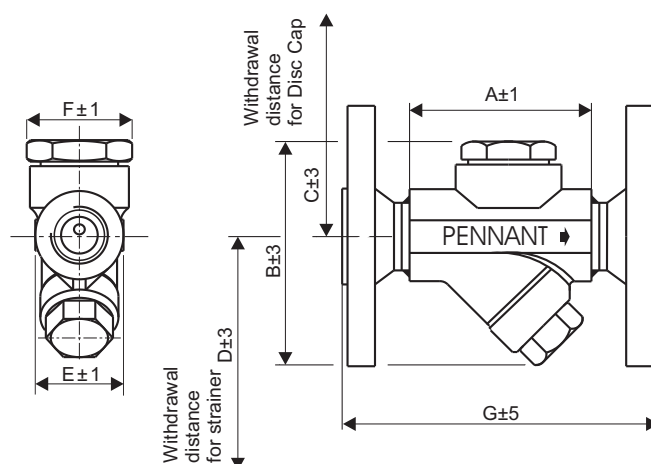
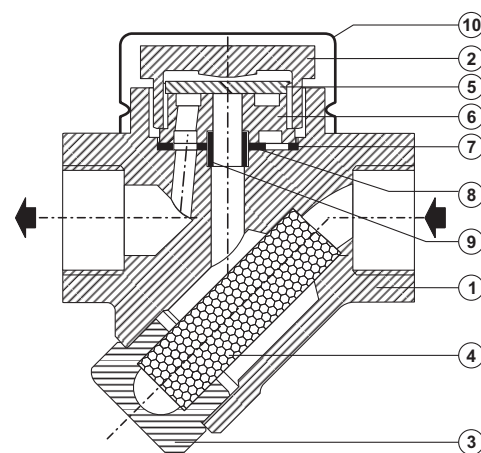

ISO 9001 : 2000 CERTIFIED COMPANY

PENNANT
ENGINEERING PVT LTD

Adm. Office : L 14, Ganraj Estate, Pune - Sholapur Road, Hadapsar, Pune 411 013, INDIA.
Telefax : +91 (0) 20 2687 5964.

Marketing : Tel. +91 (0) 937100 5803 / +91 (0) 20 2698 9709 Telefax: +91 (0) 20 2698 9470 / 20 2698 9709.

Email: pennant@vsnl.com / enq@pennantindia.com Website: http://www.pennantindia.com

Works : S.No. 116 (New), Gat No. 976 (Old), Wadki, Taluka Haveli, Pune - 412 308, INDIA.

Tel: +91 (0) 20 2698 9709 Telefax: +91 (0) 20 2698 9470