

DESCRIPTION :

Moisture separators suitable for various pressure - temperature conditions. Fabricated from high class pipes, flanges and baffle plates.

SIZES :

DN15, 20, 25, 40, 50, 65, 80, 100, 125, 150, 200, 250 & 300

CONNECTIONS :

Flanged to ANSI 150, 300 & 600.
BS & DIN flanges available on request.
Non IBR¹ / IBR approved.

LIMITING CONDITIONS:

Maximum working pressure & temperature as per flange ratings.

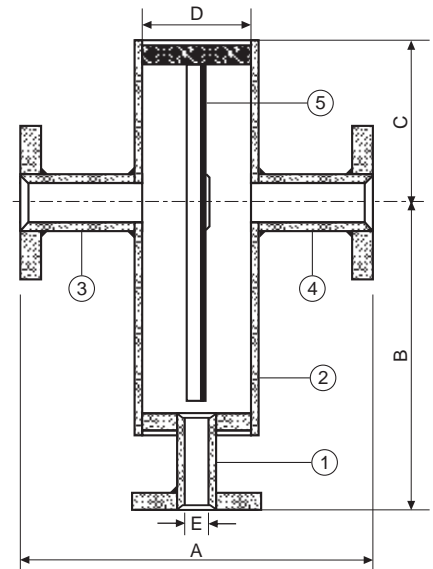

MATERIAL:

No.	PART	MATERIAL	QTY. (Nos.)
1.	DRAIN	ASTM A106 Gr. B / ERW-Class 'C'	1
2.	BODY		
3.	INTLET		
4.	OUTLET		
5.	BAFFLE PLATE	I.S. 2002 Fl. / I.S. 226	1

DIMENSIONS - Nominal in mm

SIZE	A	B	C	D	E
DN15	216	203	100	80	15
DN20	241	203	143	80	15
DN25	318	276	149	100	25
DN40	368	295	149	100	25
DN50	470	355	222	150	25
DN65	470	387	225	150	25
DN80	470	477	238	150	25
DN100	575	515	279	200	25
DN125	673	619	346	250	25
DN150	749	775	394	300	25
DN200	870	841	517	400	25
DN250	900	912	610	400	25
DN300	929	960	660	450	25

¹Indian Boiler Regulations

Local regulations may restrict the use of this product below the conditions quoted. Limiting conditions refer to standard connections only. In the interest of development and improvement of the product, we reserve the right to change the specifications without prior notice.